

To suit walls with: Outer: 95mm - 115mm, Cavity: 57mm - 71mm, Inner: 175mm -

Cavity Wall Lintels - 100/60/175

LIGHT/STANDARD DUTY SC60EEa

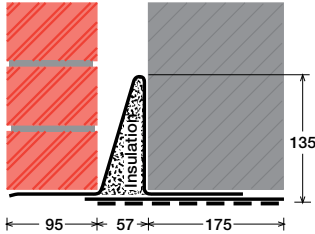

Lintel Section Properties

Ixx	394.92 cm ⁴
Zxx	37.53 cm ³
Weight	19.48 kg/m
Area	24.79 cm ²
Ryy	7.04 cm

Typical Optional Features

Option	Spec. Suffix
Lintray (see p6)	Prefix /L
Feature Brick (see p9)	Suffix /FB
Outer step 20mm	Suffix /ST
Flat Base (no plaster key)	Suffix /F
Cant Outer (50mm)	Suffix /C
Wide Outer (125mm)	Suffix /WO

Permissible Load Ratio 1:1 - 1:5

Lintel Load Capacity Table

Opening Span	Lintel Length	Safe Load kN
600	900	35
750	1050	35
900	1200	35
1050	1350	35
1200	1500	33
1350	1650	30
1500	1800	25
1650	1950	25
1800	2100	20
1950	2250	20
2100	2400	20
2250	2550	19

Where no load is shown a heavier duty lintel is needed

STANDARD DUTY SC60EEb

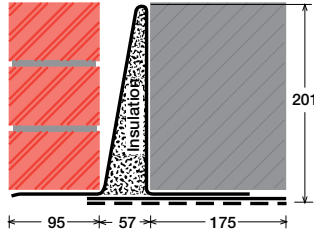

Lintel Section Properties

Ixx	1188.66 cm ⁴
Zxx	79.45 cm ³
Weight	23.12 kg/m
Area	29.43 cm ²
Ryy	6.58 cm

Typical Optional Features

Option	Spec. Suffix
Lintray (see p6)	Prefix /L
Feature Brick (see p9)	Suffix /FB
Outer step of 20mm	Suffix /ST
Flat Base (no plaster key)	Suffix /F
Cant Outer (50mm)	Suffix /C
Wide Outer (125mm)	Suffix /WO

Permissible Load Ratio 1:1 - 1:5

Lintel Load Capacity Table

Opening Span	Lintel Length	Safe Load kN
600	900	50
750	1050	50
900	1200	50
1050	1350	50
1200	1500	50
1350	1650	50
1500	1800	50
1650	1950	50
1800	2100	50
1950	2250	46
2100	2400	43
2250	2550	41
2400	2700	38
2550	2850	36
2700	3000	34
2850	3150	33
3000	3300	30
3150	3450	30
3300	3600	28
3450	3750	27
3600	3900	26
3750	4050	25
3900	4200	24
4050	4350	23
4200	4500	22
4350	4650	21
4500	4800	20

MEDIUM DUTY MC60EEa

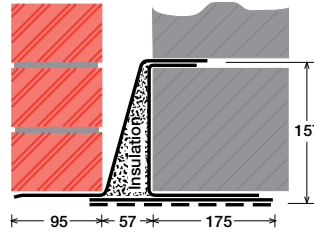

Lintel Section Properties

Ixx	1066.21 cm ⁴
Zxx	99.99 cm ³
Weight	22.81 kg/m
Area	29.03 cm ²
Ryy	6.32 cm

Typical Optional Features

Option	Spec. Suffix
Lintray (see p6)	Prefix /L
Feature Brick (see p9)	Suffix /FB
Outer step of 20mm	Suffix /ST
Flat Base (no plaster key)	Suffix /F
Cant Outer (50mm)	Suffix /C
Wide Outer (125mm)	Suffix /WO

Permissible Load Ratio 1:1 - 1:19

Lintel Load Capacity Table

Opening Span	Lintel Length	Safe Load kN
600	900	40
750	1050	40
900	1200	40
1050	1350	40
1200	1500	40
1350	1650	40
1500	1800	40
1650	1950	40
1800	2100	40
1950	2250	40
2100	2400	40
2250	2550	40
2400	2700	40
2550	2850	40
2700	3000	40
2850	3150	40
3000	3300	39
3150	3450	37
3300	3600	36
3450	3750	34
3600	3900	32
3750	4050	30
3900	4200	28
4050	4350	26
4200	4500	24
4350	4650	22
4500	4800	21

MEDIUM/HEAVY DUTY MC60EEb

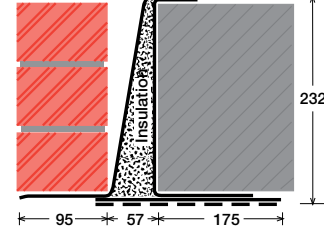

Lintel Section Properties

Ixx	2501.53 cm ⁴
Zxx	161.15 cm ³
Weight	26.33 kg/m
Area	33.52 cm ²
Ryy	5.92 cm

Typical Optional Features

Option	Spec. Suffix
Lintray (see p6)	Prefix /L
Feature Brick (see p9)	Suffix /FB
Outer step of 20mm	Suffix /ST
Flat Base (no plaster key)	Suffix /F
Cant Outer (50mm)	Suffix /C
Wide Outer (125mm)	Suffix /WO

Permissible Load Ratio 1:1 - 1:19

Lintel Load Capacity Table

Opening Span	Lintel Length	Safe Load kN
600	900	60
750	1050	60
900	1200	60
1050	1350	60
1200	1500	60
1350	1650	60
1500	1800	60
1650	1950	60
1800	2100	60
1950	2250	60
2100	2400	60
2250	2550	60
2400	2700	60
2550	2850	60
2700	3000	60
2850	3150	60
3000	3300	60
3150	3450	60
3300	3600	58
3450	3750	56
3600	3900	53
3750	4050	50
3900	4200	50
4050	4350	48
4200	4500	46
4350	4650	45
4500	4800	43

We can make even wider inners! Suffix/WI

Within this basic wall construction there is considerable scope to tailor the section shape to your exact requirement using our many options and usually the lead time remains the same! These examples show possible option specifications:

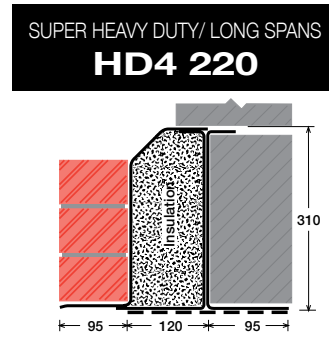
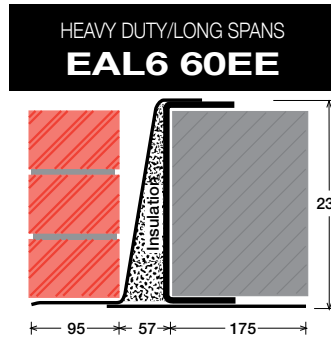
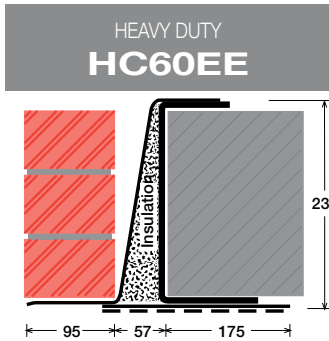

SC60EEa/WO

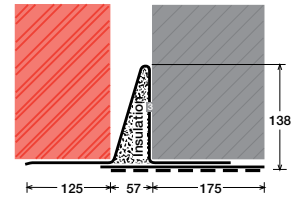

Lintel shown with optional wide outer (WO)

Lintel Section Properties

lxx	3592.43 cm4
Zxx	241.63 cm3
Weight	36.26 kg/m
Area	46.15 cm2
Ryy	5.67 cm

Typical Optional Features

Option	Spec. Suffix
Lintray (see p6)	Prefix /L
Feature Brick (see p9)	Suffix /FB
Outer step of 20mm	Suffix /ST
Flat Base (no plaster key)	Suffix /F
Cant Outer (50mm)	Suffix /C
Wide Outer (125mm)	Suffix /WO

Lintel Section Properties

lxx	5815.80 cm4
Zxx	417.31 cm3
Weight	52.75 kg/m
Area	67.15 cm2
Ryy	5.17 cm

Typical Optional Features

Option	Spec. Suffix
Lintray (see p6)	Prefix /L
Feature Brick (see p9)	Suffix /FB
Outer step of 20mm	Suffix /ST
Flat Base (no plaster key)	Suffix /F
Cant Outer (50mm)	Suffix /C
Wide Outer (125mm)	Suffix /WO

Lintel Section Properties

lxx	7640.74 cm4
Zxx	449.27 cm3
Weight	45.52 kg/m
Area	57.95 cm2
Ryy	6.27 cm

Typical Optional Features

Option	Spec. Suffix
Lintray (see p6)	Prefix /L
Feature Brick (see p9)	Suffix /FB
Outer step of 20mm	Suffix /ST
Flat Base (no plaster key)	Suffix /F
Cant Outer (50mm)	Suffix /C
Wide Outer (125mm)	Suffix /WO

MC60EEa/ST/C50

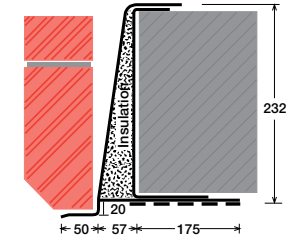

Lintel shown with optional step (ST) and cant (C)

MC60EEb/C

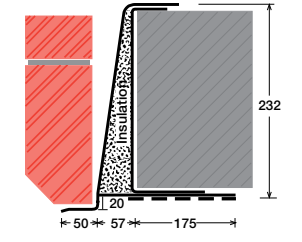

Lintel shown with optional cant (C)

MC60EEb/F

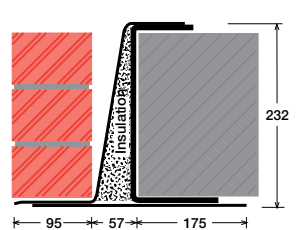

Lintel shown with optional flat base (F)

Permissible Load Ratio 1:1 - 1:19

Permissible Load Ratio 1:1 - 1:19

Permissible Load Ratio 1:1 - 1:19

Lintel Load Capacity Table

Lintel Load Capacity Table

Lintel Load Capacity Table

Opening Span	Lintel Length	Safe Load kN
600	900	80
750	1050	80
900	1200	80
1050	1350	80
1200	1500	80
1350	1650	80
1500	1800	80
1650	1950	80
1800	2100	80
1950	2250	80
2100	2400	80
2250	2550	80
2400	2700	80
2550	2850	80
2700	3000	80
2850	3150	80
3000	3300	80
3150	3450	80
3300	3600	80
3450	3750	78
3600	3900	74
3750	4050	72
3900	4200	69
4050	4350	64
4200	4500	62
4350	4650	60
4500	4800	60

Opening Span	Lintel Length	Safe Load kN
600	900	190
900	1200	190
1200	1500	190
1500	1800	190
1800	2100	190
2100	2400	190
2400	2700	190
2700	3000	190
3000	3300	190
3300	3600	174
3600	3900	160
3900	4200	148
4200	4500	137
4500	4800	120
4800	5100	106
5100	5400	94
5400	5700	84
5700	6000	76
6000	6300	68
6300	6600	62
6600	6900	57
6900	7200	52
7200	7500	48
7500	7800	44
7800	8100	41
8100	8400	38

Opening Span	Lintel Length	Safe Load kN
600	900	196
900	1200	196
1200	1500	196
1500	1800	196
1800	2100	196
2100	2400	196
2400	2700	196
2700	3000	196
3000	3300	196
3300	3600	187
3600	3900	172
3900	4200	159
4200	4500	148
4500	4800	139
4800	5100	130
5100	5400	123
5400	5700	111
5700	6000	100
6000	6300	90
6300	6600	82
6600	6900	75
6900	7200	68
7200	7500	63
7500	7800	58
7800	8100	54
8100	8400	50

For material spec. see page 72

*Stainless Steel only