

Outer Leaf Lintels

O1

CAVITY: 30-150

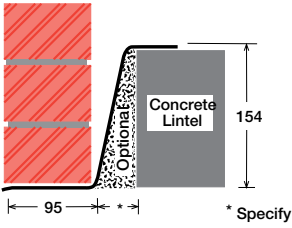

Lintel Section Properties

Ixx	376.00 cm ⁴
Zxx	45.39 cm ³
Weight	7.52 kg/m
Area	9.57 cm ²
Ryy	4.99 cm

O2

CAVITY: 30-150

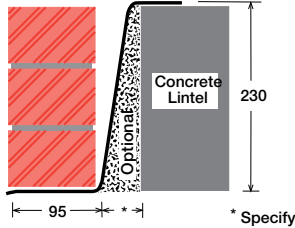

Lintel Section Properties

Ixx	818.00 cm ⁴
Zxx	63.10 cm ³
Weight	8.72 kg/m
Area	11.10 cm ²
Ryy	4.20 cm

O2/4

CAVITY: 40-115

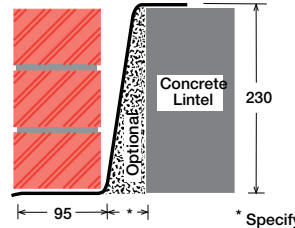

Lintel Section Properties

Ixx	1261.75 cm ⁴
Zxx	99.25 cm ³
Weight	14.10 kg/m
Area	17.94 cm ²
Ryy	3.66 cm

O3

CAVITY: 40-115

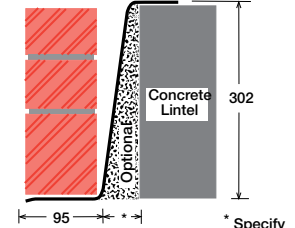

Lintel Section Properties

Ixx	1898.37 cm ⁴
Zxx	116.84 cm ³
Weight	12.99 kg/m
Area	192.00 cm ²
Ryy	3.39 cm

Typical Optional Features

Option	Spec. Suffix
Lintray® :	/ L
Cavity 50mm :	/ 50
Cavity 60mm :	/ 60
Cavity 75mm :	/ 75
Cavity 90mm :	/ 90
Cavity 100mm :	/ 100
Cant Outer (50mm) :	/ C
Wide Outer (125mm) :	/ WO
Bonded Insulation :	/ BI

Typical Optional Features

Option	Spec. Suffix
Lintray® :	/ L
Cavity 50mm :	/ 50
Cavity 60mm :	/ 60
Cavity 75mm :	/ 75
Cavity 90mm :	/ 90
Cavity 100mm :	/ 100
Cant Outer (50mm) :	/ C
Wide Outer (125mm) :	/ WO
Bonded Insulation :	/ BI

Typical Optional Features

Option	Spec. Suffix
Lintray® :	/ L
Cavity 50mm :	/ 50
Cavity 60mm :	/ 60
Cavity 75mm :	/ 75
Cavity 90mm :	/ 90
Cavity 100mm :	/ 100
Cant Outer (50mm) :	/ C
Wide Outer (125mm) :	/ WO
Bonded Insulation :	/ BI

Typical Optional Features

Option	Spec. Suffix
Lintray® :	/ L
Cavity 50mm :	/ 50
Cavity 60mm :	/ 60
Cavity 75mm :	/ 75
Cavity 90mm :	/ 90
Cavity 100mm :	/ 100
Cant Outer (50mm) :	/ C
Wide Outer (125mm) :	/ WO
Bonded Insulation :	/ BI

Lintel Load Capacity Table

Opening Span	Lintel Length	Safe Load kN
600	900	6
750	1050	6
900	1200	6
1050	1350	6
1200	1500	6
1350	1650	6

Lintel Load Capacity Table

Opening Span	Lintel Length	Safe Load kN
600	900	25
750	1050	25
900	1200	25
1050	1350	25
1200	1500	25
1350	1650	25
1500	1800	25
1650	1950	25
1800	2100	25
1950	2250	25
2100	2400	25
2250	2550	25
2400	2700	25
2550	2850	25
2700	3000	24
2850	3150	23
3000	3300	23
3150	3450	22
3300	3600	21
3450	3750	20
3600	3900	20
3750	4050	19
3900	4200	18
4050	4350	17
4200	4500	17
4350	4650	16
4500	4800	16

Lintel Load Capacity Table

Opening Span	Lintel Length	Safe Load kN
600	900	30
750	1050	30
900	1200	30
1050	1350	30
1200	1500	30
1350	1650	30
1500	1800	30
1650	1950	30
1800	2100	30
1950	2250	30
2100	2400	30
2250	2550	30
2400	2700	30
2550	2850	30
2700	3000	30
2850	3150	30
3000	3300	30
3150	3450	27
3300	3600	26
3450	3750	24
3600	3900	23
3750	4050	23
3900	4200	22
4050	4350	21
4200	4500	21
4350	4650	20
4500	4800	20

Lintel Load Capacity Table

Opening Span	Lintel Length	Safe Load kN
600	900	40
750	1050	40
900	1200	40
1050	1350	40
1200	1500	40
1350	1650	40
1500	1800	40
1650	1950	40
1800	2100	40
1950	2250	40
2100	2400	40
2250	2550	40
2400	2700	40
2550	2850	40
2700	3000	40
2850	3150	40
3000	3300	40
3150	3450	37
3300	3600	36
3450	3750	34
3600	3900	33
3750	4050	33
3900	4200	31
4050	4350	30
4200	4500	28
4350	4650	27
4500	4800	26

Where no load is shown a heavier duty lintel is needed