

Brick tray

T section range Soldier or Gauged brick 365 mm high

Section at span

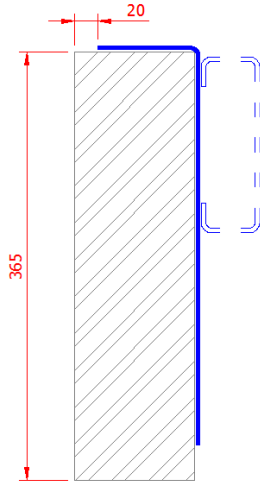

The HD option will have a back channel for increased stability

Section at bearing

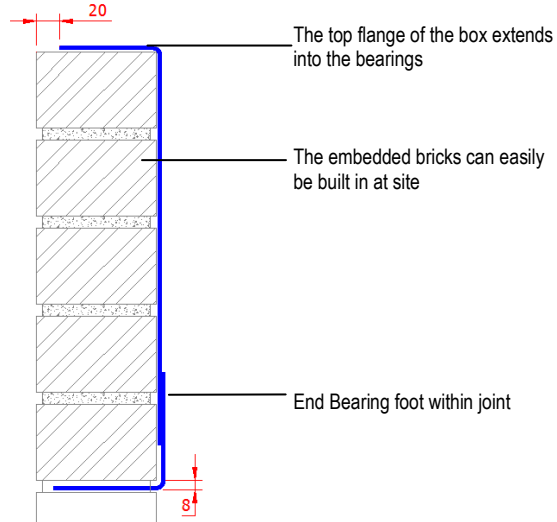

T365/3	
Lintel section properties	
Ixx	1540 cm ⁴
Zxx	76.10 cm ³
Weight	10.10 kg/m
Area	12.60 cm
Ryy	2.00 cm

T365/4	
Lintel section properties	
Ixx	2064 cm ⁴
Zxx	101.00 cm ³
Weight	13.50 kg/m
Area	16.88 cm
Ryy	2.05 cm

T365/6	
Lintel section properties	
Ixx	3128 cm ⁴
Zxx	153.00 cm ³
Weight	20.33 kg/m
Area	25.40 cm
Ryy	2.09 cm

T365/4 - HD	
Lintel section properties	
Ixx	2557 cm ⁴
Zxx	111.00 cm ³
Weight	20.50 kg/m
Area	25.70 cm
Ryy	2.75 cm

Lintel load Capacity Table		
Opening Span	Lintel Length	Safe Load kN
600	900	116.7
900	1200	77.8
1200	1500	58.3
1500	1800	46.7
1800	2100	38.9
2100	2400	33.3
2400	2700	29.2
2700	3000	25.9
3000	3300	23.3
3300	3600	21.2
3600	3900	19.4

Lintel load Capacity Table		
Opening Span	Lintel Length	Safe Load kN
600	900	154.9
900	1200	103.2
1200	1500	77.4
1500	1800	61.9
1800	2100	51.6
2100	2400	44.2
2400	2700	38.7
2700	3000	34.4
3000	3300	31.0
3300	3600	28.2
3600	3900	25.8
3900	4200	23.8

Lintel load Capacity Table		
Opening Span	Lintel Length	Safe Load kN
600	900	234.6
900	1200	156.4
1200	1500	117.3
1500	1800	93.8
1800	2100	78.2
2100	2400	67.0
2400	2700	58.7
2700	3000	52.1
3000	3300	46.9
3300	3600	42.7
3600	3900	39.1
3900	4200	36.1
4200	4500	33.5
4500	4800	31.3

Lintel load Capacity Table		
Opening Span	Lintel Length	Safe Load kN
600	900	170.2
900	1200	113.5
1200	1500	85.1
1500	1800	68.1
1800	2100	56.7
2100	2400	48.6
2400	2700	42.6
2700	3000	37.8
3000	3300	34.0
3300	3600	30.9
3600	3900	28.4
3900	4200	26.2
4200	4500	24.3

Our unique bearings allow site brickwork to be build butting the brick slip arch, this system gives both a high and low level bearing.

The section provides a bearing on the top flange with a second bearing at the "foot". The bricks at the bearing also fully fill between the top and bottom bearing.

Loadings are shown above to assist you in your selection 102.5mm brickwork is 2.2 kN/m² 215mm dimensions can be varied to suit imperial and other brick sizes